

MAIN FLOOR

967 SQ. FT.

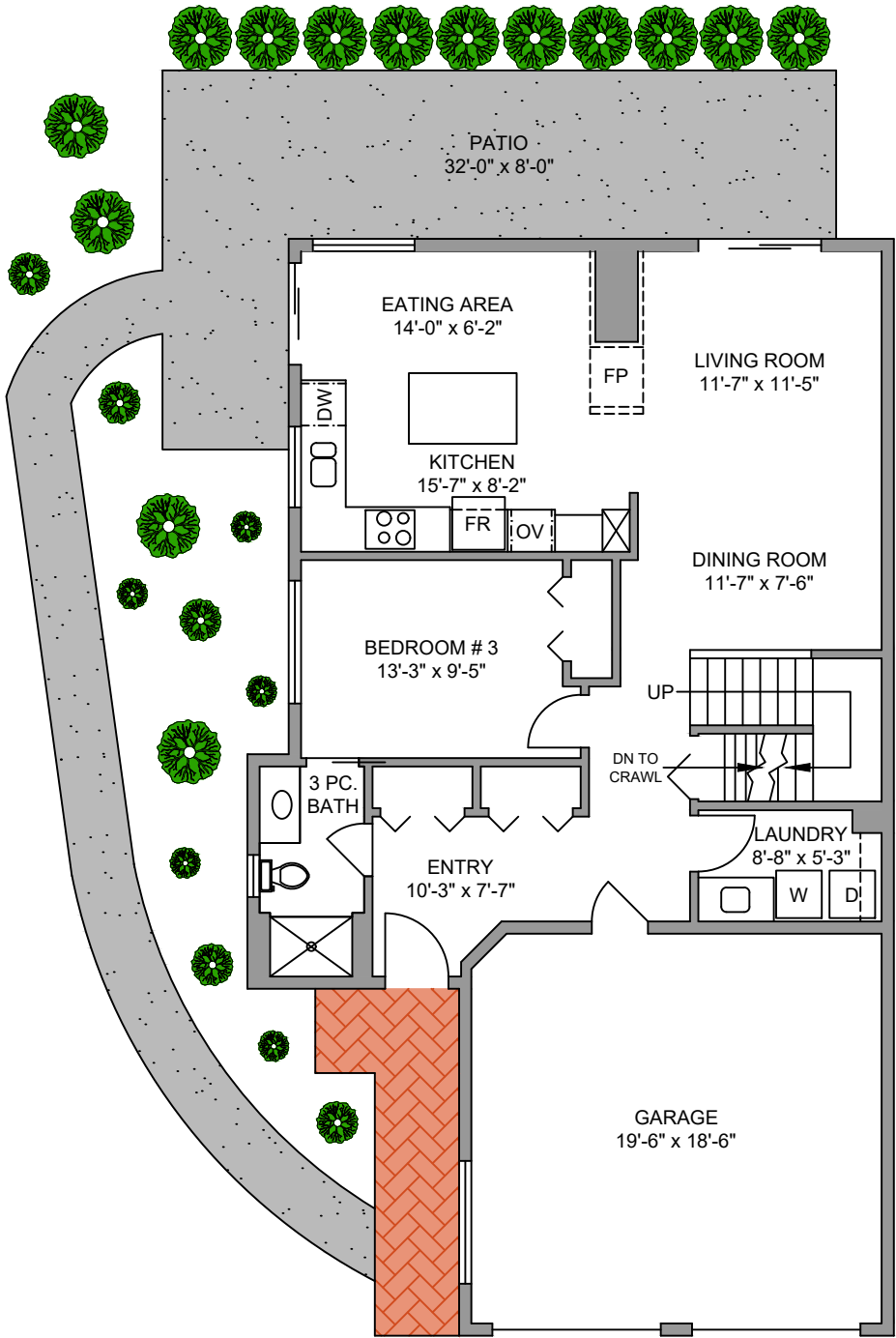

UPPER FLOOR

728 SQ. FT.

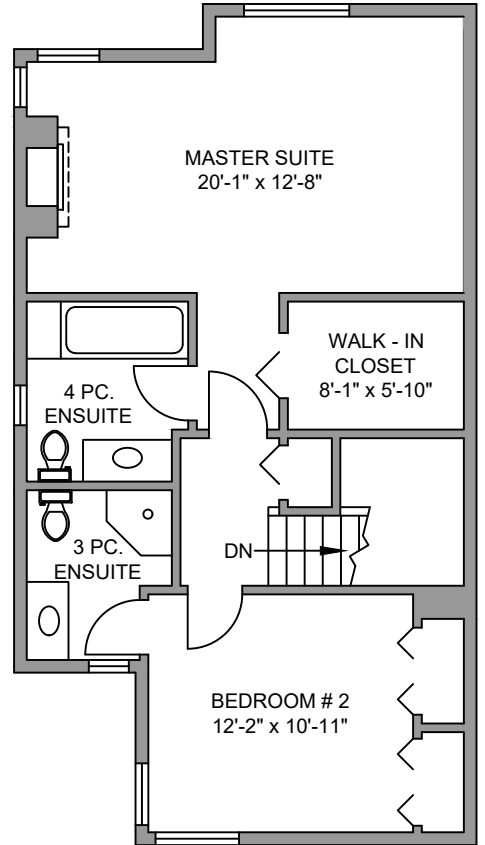

NORTH

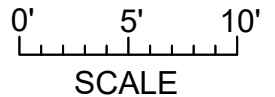

 **Kimberly** LEGEARD
UNIQUE HOMES VICTORIA.COM



PROPERMEASURE™
PRECISION

250-884-9753
matt@propermeasure.com
www.propermeasure.com

#5 - 2235 HARBOUR ROAD JULY 28, 2020 PREPARED FOR THE EXCLUSIVE USE OF KIMBERLY LEGEARD PLANS MAY NOT BE 100% ACCURATE, IF CRITICAL BUYER TO VERIFY.			
FLOOR	AREA (SQ. FT.)		
	FINISHED	GARAGE	DECK / PATIO
MAIN	967	377	316
UPPER	728	0	0
TOTAL	1695	377	316